

Illustrated Index

Rear Cover

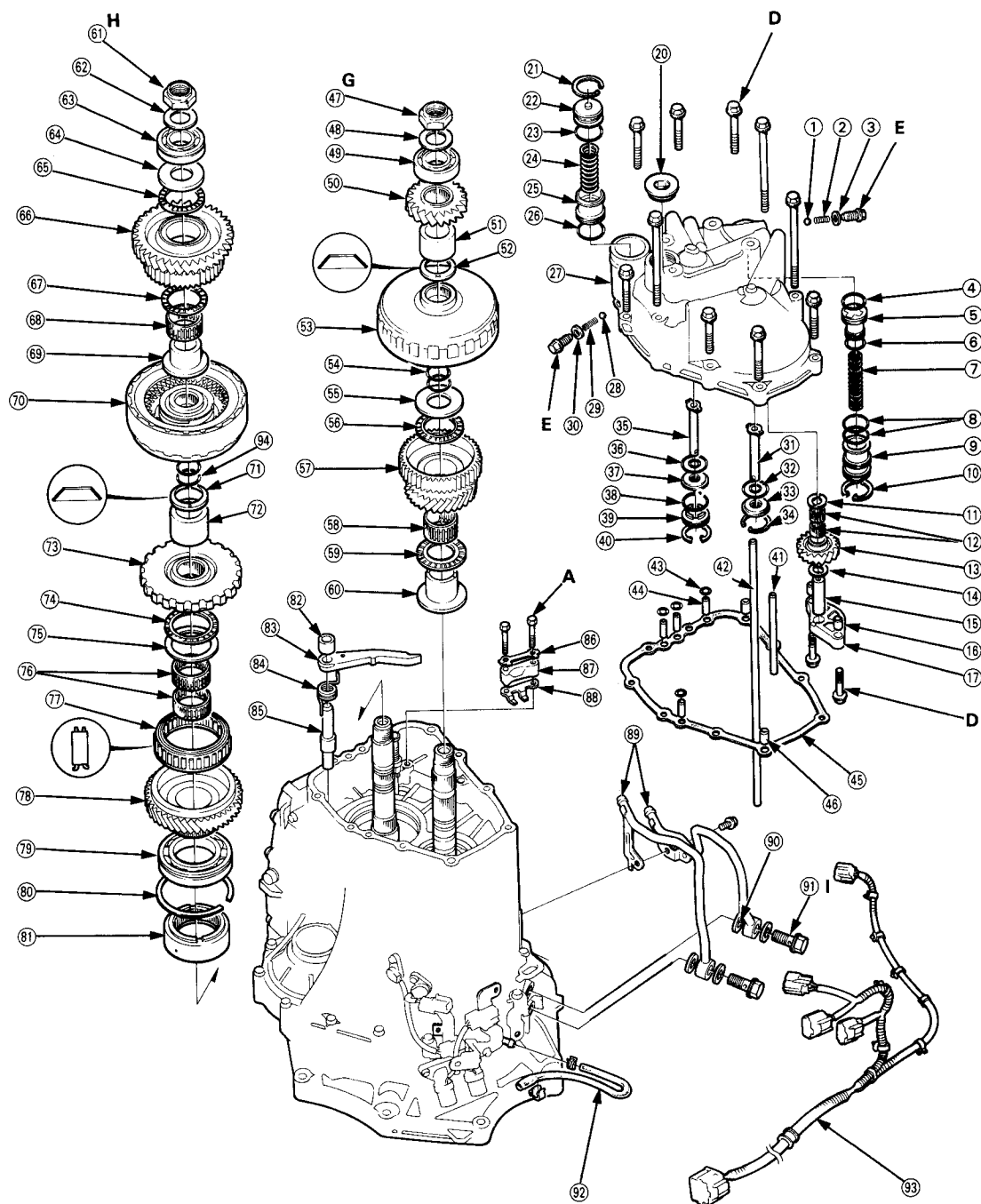



- | | | | |
|----|---------------------------------|----|---|
| ① | STEEL BALL | ④⑨ | BALL BEARING |
| ② | ONE-WAY BALL SPRING | ⑤⑩ | MAINSHAFT REVERSE GEAR |
| ③ | SEALING WASHER Replace. | ⑤⑪ | MAINSHAFT REVERSE GEAR DISTANCE COLLAR |
| ④ | O-RING Replace. | ⑤⑫ | MAINSHAFT DISC SPRING 28 mm |
| ⑤ | REVERSE ACCUMULATOR PISTON | | Replace. |
| ⑥ | O-RING Replace. | ⑤⑬ | 2ND CLUTCH ASSEMBLY |
| ⑦ | REVERSE ACCUMULATOR SPRING | ⑤⑭ | O-RING Replace. |
| ⑧ | O-RING Replace. | ⑤⑮ | THRUST SHIM 29 mm |
| ⑨ | REVERSE ACCUMULATOR SLEEVE | ⑤⑯ | THRUST NEEDLE BEARING |
| ⑩ | SNAP RING | ⑤⑰ | MAINSHAFT 2ND GEAR |
| ⑪ | THRUST SHIM 14 x 30 mm | ⑤⑱ | NEEDLE BEARING |
| ⑫ | NEEDLE BEARINGS | ⑤⑲ | THRUST NEEDLE BEARING |
| ⑬ | REVERSE IDLER GEAR | ⑤⑳ | MAINSHAFT 2ND GEAR COLLAR |
| ⑭ | THRUST SHIM 14 x 25 mm | ⑤㉑ | COUNTERSHAFT LOCKNUT 24 x 1.25 mm |
| ⑮ | REVERSE IDLER GEAR SHAFT | | Replace. |
| ⑯ | DOWEL PIN | ⑤㉒ | WASHER 24 mm |
| ⑰ | REVERSE IDLER GEAR SHAFT HOLDER | ⑤㉓ | BALL BEARING |
| ⑲ | SEALING BOLT 34 x 1.25 mm | ⑤㉔ | THRUST SHIM 25 mm |
| ⑳ | SNAP RING | ⑤㉕ | THRUST NEEDLE BEARING |
| ㉑ | 1ST-HOLD ACCUMULATOR SLEEVE | ⑤㉖ | COUNTERSHAFT REVERSE GEAR |
| ㉒ | O-RING Replace. | ⑤㉗ | THRUST NEEDLE BEARING |
| ㉓ | 1ST-HOLD ACCUMULATOR SPRING | ⑤㉘ | NEEDLE BEARING |
| ㉔ | 1ST-HOLD ACCUMULATOR PISTON | ⑤㉙ | COUNTERSHAFT REVERSE GEAR COLLAR |
| ㉕ | O-RING Replace. | ⑤㉚ | REVERSE CLUTCH ASSEMBLY |
| ㉖ | REAR COVER | ⑤㉛ | COUNTERSHAFT DISC SPRING 29 mm |
| ㉗ | STEEL BALL | | Replace. |
| ㉘ | ONE-WAY BALL SPRING | ⑤㉜ | REVERSE CLUTCH DISTANCE COLLAR |
| ㉙ | SEALING WASHER Replace. | ⑤㉝ | PARKING GEAR |
| ㉚ | 2ND CLUTCH FEED PIPE | ⑤㉞ | THRUST NEEDLE BEARING |
| ㉛ | O-RING Replace. | ⑤㉟ | THRUST SHIM 45.5 x 60 mm Selective part |
| ㉜ | FEED PIPE GUIDE | ⑤㊱ | NEEDLE BEARINGS |
| ㉝ | SNAP RING | ⑤㊲ | 2ND GEAR ONE-WAY CLUTCH |
| ㉞ | REVERSE CLUTCH FEED PIPE | ⑤㊳ | COUNTERSHAFT 2ND GEAR |
| ㉟ | O-RING Replace. | ⑤㊴ | BALL BEARING |
| ㊱ | FEED PIPE GUIDE | ⑤㊵ | SNAP RING |
| ㊲ | O-RING Replace. | ⑤㊶ | ONE-WAY CLUTCH HUB |
| ㊳ | OIL FEED GUIDE | ⑤㊷ | PARKING BRAKE PAWL SHAFT SLEEVE |
| ㊴ | SNAP RING | ⑤㊸ | PARKING BRAKE PAWL |
| ㊵ | FEED PIPE | ⑤㊹ | PARKING BRAKE PAWL SPRING |
| ㊶ | FEED PIPE | ⑤㊺ | PARKING BRAKE PAWL SHAFT |
| ㊷ | O-RING Replace. | ⑤㊻ | LOCK PLATE Replace. |
| ㊸ | OIL PIPE | ⑤㊼ | PARKING BRAKE ROD HOLDER |
| ㊹ | REAR COVER GASKET Replace. | ⑤㊽ | PARKING BRAKE ROD GUIDE |
| ㊺ | DOWEL PIN | ⑤㊾ | ATF COOLER PIPES |
| ㊻ | MAINSHAFT LOCKNUT 24 x 1.25 mm | ⑤㊿ | SEALING WASHER Replace. |
| | Replace. | ⑥① | JOINT BOLT |
| ④⑧ | WASHER 24 mm | ⑥② | BREATHER PIPE |
| | | ⑥③ | TRANSMISSION SUB-HARNESS |
| | | ⑥④ | O-RING Replace. |

TORQUE SPECIFICATIONS

No.	Torque Value	Bolt Size	Remarks
A	12 N·m (1.2 kg-m, 9 lb-ft)	6 x 1.0 mm	
D	27 N·m (2.7 kg-m, 20 lb-ft)	8 x 1.25 mm	
E	18 N·m (1.8 kg-m, 13 lb-ft)	8 x 1.25 mm	Sealing Bolt
G	170 N·m (17.0 kg-m, 123 lb-ft)	24 x 1.25 mm	Mainshaft Locknut
H	170 N·m (17.0 kg-m, 123 lb-ft)	24 x 1.25 mm	Countershaft Locknut (Left-hand threads)
I	40 N·m (4.0 kg-m, 29 lb-ft)	14 x 1.5 mm	Joint Bolt